

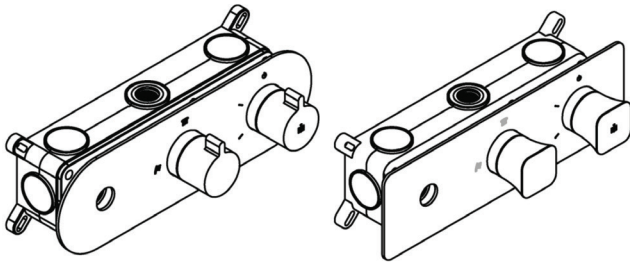

INSTALLATION MANUAL

Product name: **TWO-WAY CONCEALED SHOWER MIXER**

Model number: HAT-MX071, MX072



Note: this manual is applicable for MX071-(round), MX072-(square)

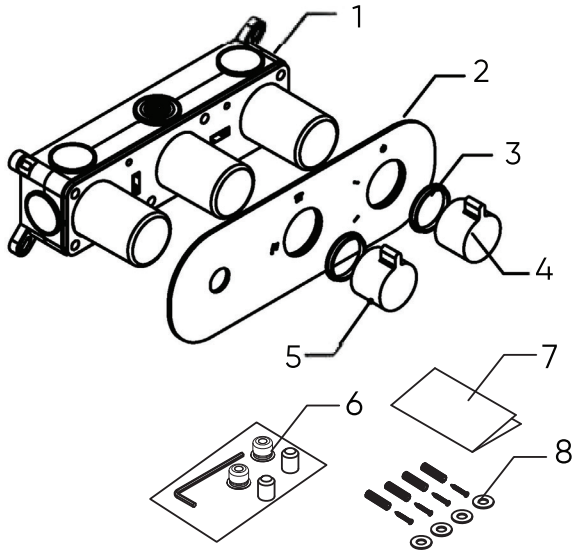

No.	Name	Qty
1	Concealed Box	1
2	Decorative frames	1
3	Wearing ring	2
4	Control handle	1
5	Diverter Handle	1
6	Accessories	1
7	Manual	1
8	Fixing Screw	1

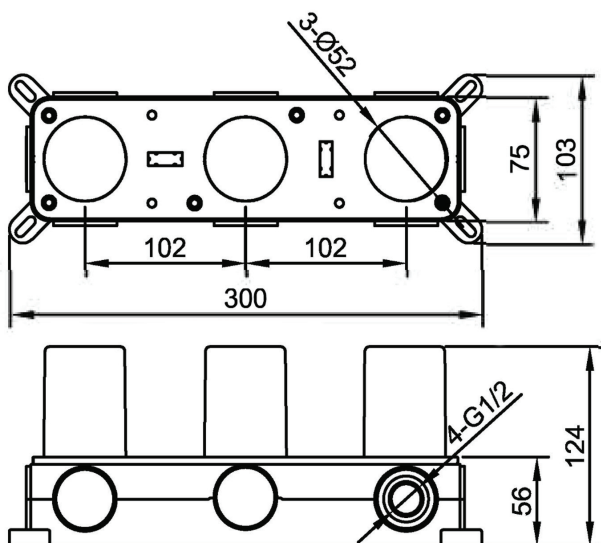

Note: this manual unit is "mm"

SUGGESTED SIZE
unit: "mm"

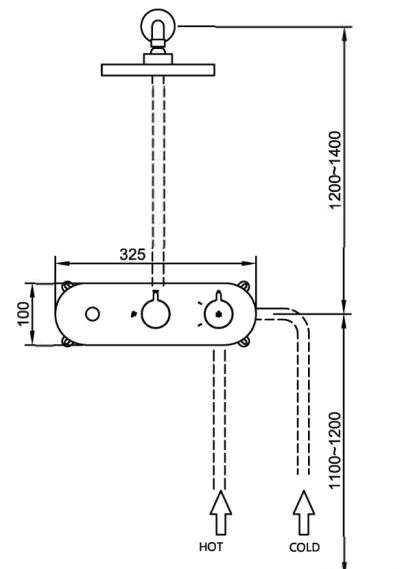

RECOMMENDED EMBEDDED

SETUP INSTRUCTIONS

The Solid wall installation

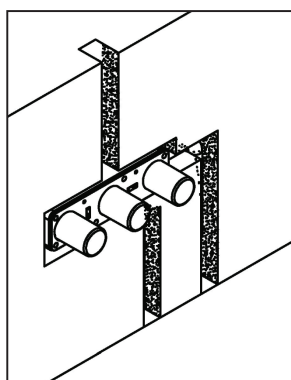
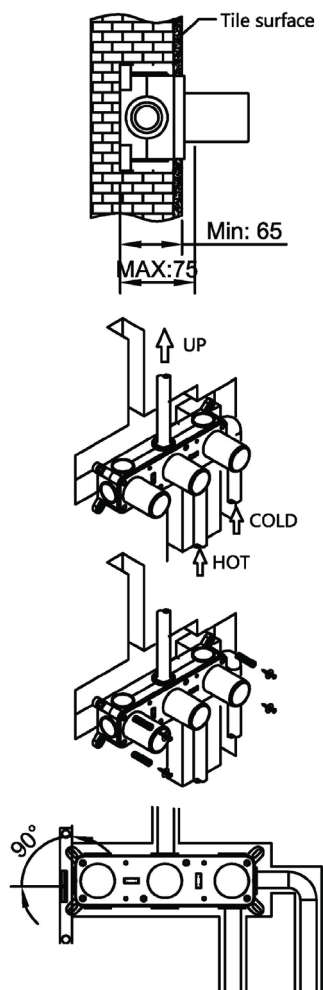

STEPS

- 1 Cut the solid wall according to the box size to be sure the depth of from the tile surface to the bottom of the box is between 75-65mm. For example, if it is 20mm depth increasing after pasting the tile, the solid wall opening depth should be 40-55 mm.
- 2 The size of the opening is based on the principle of easy installation of the embedded box.
- 3 The bottom of the opening should be kept flat to facilitate the subsequent adjustment of the vertical and horizontal position of the embedded box.
- 4 Connect the hot water line with the left water inlet hose and cold water on the right while mixed water outlet will be up.
- 5 After the pipeline connection is completed, the corresponding pipeline grooves are opened on the rough wall according to the pipeline layout.
- 6 Keep the mixed water outlet open and the water pipeline clean before testing the pipeline.
- 7 Before the test, open the switch valve core and turn on the water source to test whether the left and right water inlet pipes are tightly connected without leakage. After the water inlet pipe test is completed, adjust the flow switch to the open state to test whether the upper mixed water outlet pipe is tightly connected without leakage. At the same time, keep it for a while to clean the pipe foreign matter to prevent affecting the water outlet function of the control valve.
- 8 Open the handle cartridge and left and right water inlet pipes to be sure there isn't leakage. After the water inlet pipe test is completed, adjust the flow rate cartridge to be sure mixer water outlet pipe is without leakage. Meanwhile, keep it for a while to clean the pipe and prevent affecting the water outlet function of the cartridge.
- 9 Fixing the embodied box into the wall with plastic wall plug and screws. Do the levelling with the level built-in the box to be sure it is vertical and horizontal to avoid any difficulties for the frame installation.
- 10 Make sure the connection of all water pipes is correct and without any leakage. Seal the box and pipelines with cement after installing all components for the shower system.
- 11 Till now, the solid wall concealed part installation is finished and the exposed parts will be installed after pasting the ceramic tiles.

WARNING! Only seal the wall without leakage in the pipelines.

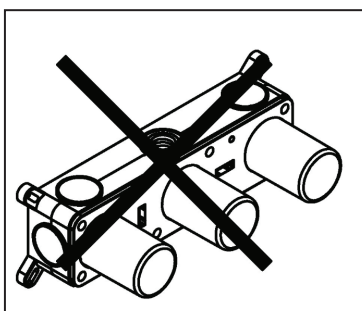

WARNING!

- 1 Keep the embodied box blocked when sealing it with cement to avoid any damage of its function.
- 2 Keep the 2.5mm Allen key in the package after installing the embedded box for further usage of exposed parts.
- 2 Leave the exposes parts in the original package before finishing the embedded box installation to avoid any scratch, missing or damage on the finish.

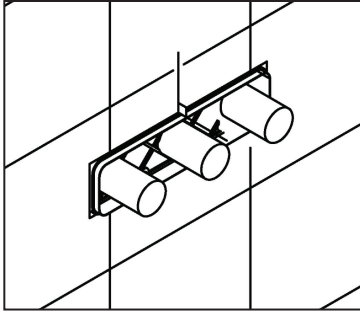

- 1 Lay wall tiles or other decorative wall surfaces, keep the wall flat and perpendicular to the embedded box at 9 degrees, and try to place the embedded

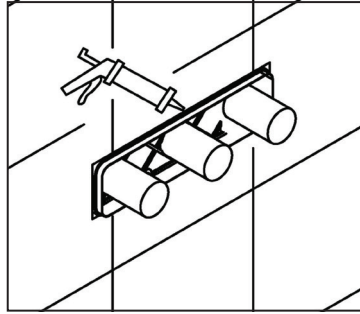

- 2 Apply glass glue along the edge of the embedded protruding part to improve the waterproof performance of the embedded box and extend its service life.

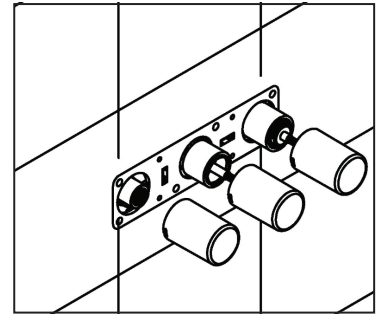

- 3 Remove the embedded box cover and water testing assembly (as shown in the figure).

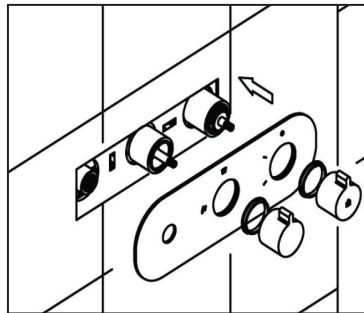

- 4 Install the frame and be sure the protective rubber is there to avoid any scratch during installing.

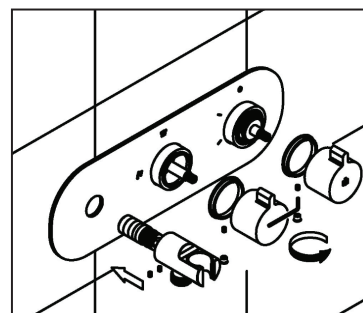

- 5 Install the handle and diverter handle, using the alien key to fix the handle to the cartridge and install the other exposed parts.

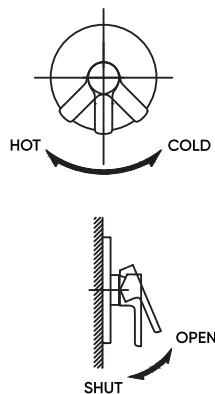

Control Valve Function

- 1 Handle up open as the main switch, opening Angle that the flow;
- 2 Handle swinging to adjust water temperature of mixing, swing to the left, hot water flow rate increases, the cold water inlet flow rate is reduced, the water temperature increases; On the other hand, to the right place, hot water reduce water flow and cold water inlet flow rate increases, the water temperature decrease;
- 3 Switch control, water mixed water direction, switch indication up showed that the mixed water when the water pipe out from the above that when water switch 90 degrees counterclockwise refers to the left, show that the mixed water out of the pipe below (single function control valve without this feature).

MAINTENANCE INSTRUCTIONS

To keep leading the surface bright and lively and good use performance, please click the following method nursing leader:

1. Rinse it with a soft cotton cloth to wipe dry only;
2. Can use mild liquid and colorless glass cleaner to remove surface dirt and scale membrane, not gear grinding effect of polishing agent;
3. Do not use abrasive cleansers, polish, emery cloth, paper towels or scraper, etc.;
4. Do not use acidic detergents, insoluble granular detergent, soap, etc.;
5. In use process, bubbler may accumulate dirt, make water decreases slowly, can open my bubble, rinse after bubbler, install back in place again can.

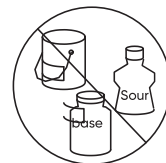
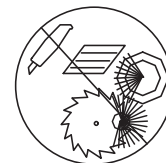

HATCH SANITARY

Hatch Sanitary is a trademark owned by MHG

Old Al Kharj Road, Building No. 3533
Riyadh 14511 - 8305
Kingdom of Saudi Arabia

© info.mhg@marketing-home.com

☎ 800 122 2230