

## HATCH KITCHEN MIXERS

**Product Name: SENSOR WASHBASIN SPOUT**  
**Model Number: HAT-MX084 - HAT MX085**

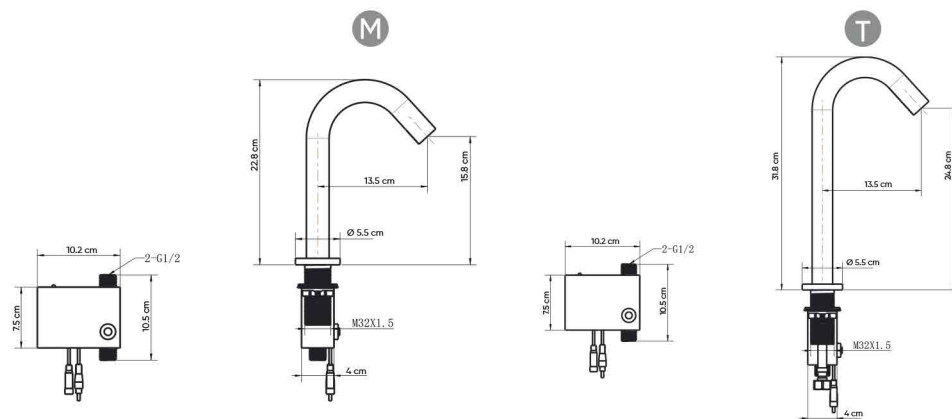

### AVAILABLE COLORS



### DESCRIPTIONS

**Material:** Brass Main body and Spout; SUS hose; ABS control Box  
**(BCC)** Black chrome coating  
**Packaging unit:** 1 piece

### DIMENSIONS

13.5 X 22.8 X 5.5 CM (M)  
 13.5 X 31.8 X 5.5 CM (T)

### TECHNICAL SPECIFICATION

**Mounting type:** Exposed  
**Average Flow rate:** 3.87 L/min  
**Maximum operating pressure:** 15 bar  
**Water consumption:** Class A  
**Spray Mode:** Stream  
**Water type:** Cold only  
**Sensor:** (Yes) Adjustable sensor range from 5 to 14 cm  
**Water inlet hose size:** 120 cm  
**Connection type:** G 1/2 in connections  
**Water outlet able to open for cleaning:** Yes  
**Battery Type:** AA-DCV6

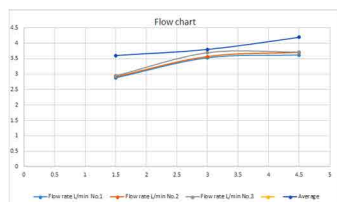

### APPLICATIONS

Bathroom/Washroom/Kitchens

### BOX COMPONENTS

- Sensor Washbasin Spout
- Plastic (ABS) Control box built-in battery
- Water inlet Hose
- Sensor wire
- Filter Key
- (SUS 304) Screws
- Fischer wall plug set
- Brass mounting rings
- Installation Manual

### COUNTRY OF ORIGIN

Made in China for HATCH Sanitary

### WARRANTY

2 years



### HATCH SANITARY

Hatch Sanitary is a trademark owned by MHG

Old Al Kharj Road, Building No. 3533  
 Riyadh 14511 - 8305  
 Kingdom of Saudi Arabia

info.mhg@marketing-home.com

800 122 2230